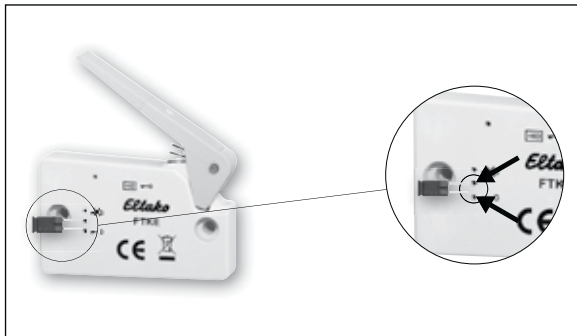
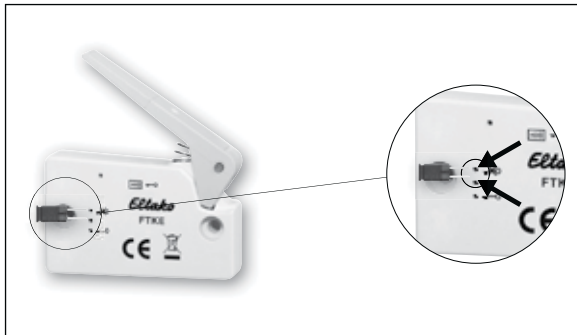

Wireless encryption plug
FVST

The encryption for the wireless window-door contacts FTKE, the wireless position switches FPE-1 and FPE-2 as well as the wireless flat pushbuttons F1FT65 and FFT55Q can be activated and deactivated with the wireless encryption plug FVST.

FTKE and FPE
Activate encryption:

Insert the encryption plug and pull the lever.

FTKE and FPE
Deactivate encryption:

Insert the encryption plug and pull the lever.

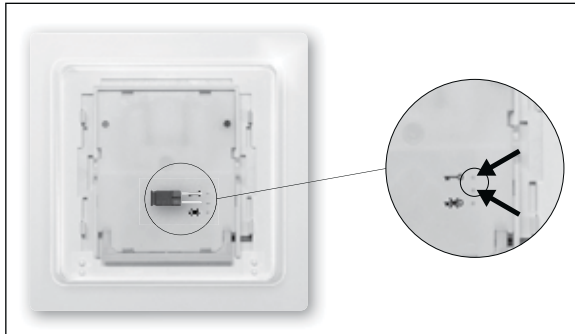
F1FT65 and FFT55Q
Activate encryption:

Insert the encryption plug and operate the rocker.

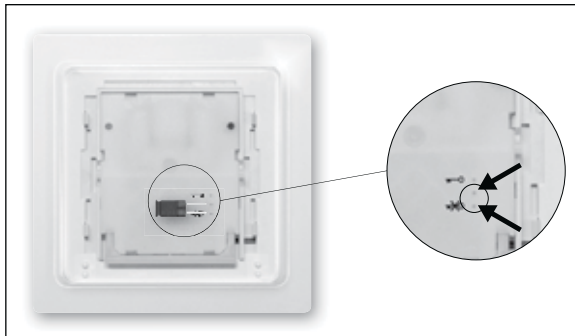
F1FT65 and FFT55Q
Deactivate encryption:

Insert the encryption plug and operate the rocker.

Must be kept for later use!
Eltako GmbH

D-70736 Fellbach

+49 711 94350000

www.eltako.com